

Orange County Boundary and Annexation Report 2011-2012 (January 1)



1. Chestnut Annexation to the City of La Habra (CA 09-11E)
2. Hensel Annexation to the City of La Habra (CA 09-10)
3. Sunset Beach Annexation to the City of Huntington Beach (IA 10-05)

	January 1, 2012 Jurisdictions
	January 1, 2011 Jurisdictions

Source: OC Geomatics, 2011 & 2012
 Note: Coastal boundary represents mean high tide circa 2015. Coastal boundary approximated by CDR GIS staff.

Orange County Boundary and Annexation Report 2011-2012

Detailed Annexation List:

- 1) Chestnut Annexation to the City of La Habra (CA 09-11E)
Effective: 1/20/2011
From Unincorporated Orange County to La Habra
Inhabited
2.68 acres (0.00419 sq. miles)
- 2) Hensel Annexation to the City of La Habra (CA 09-10)
Effective: 4/12/2011
From Unincorporated Orange County to La Habra
Inhabited
2.80 acres (0.00438 sq. miles)
- 3) Sunset Beach Annexation to the City of Huntington Beach (IA 10-05)
Effective: 8/22/2011
From Unincorporated Orange County to Huntington Beach
Inhabited
133.88 acres (0.20919 sq. miles)

Notes:
Benchmark 2015.
Some jurisdictions' legal boundary extends three miles off the coast.
A fixed boundary line at the coast was created in November 2014 based on high-resolution county-wide aerial imagery that was captured on June 19, 2013, to approximate the ocean waterline and to eliminate artificial land area changes to jurisdictions adjacent to the Orange County coast. This coast line does not define any vertical datum such as mean high tide, mean sea level, or mean lower low tide. This reference line was developed through a collaboration of OC Public Works, OC LAFCO, and CDR; it has no legal value; and its purpose is for CDR's use in reporting population density and jurisdictional annexations.
For official legal boundaries, contact the County of Orange Surveyor's office <http://ocpublicworks.com/survey/>

Jurisdiction	Total Area (Square Miles)*		Area Change 2011-2012**	Annexation Reference #
	January 1, 2011	January 1, 2012		
Aliso Viejo	6.921	6.921	0	
Anaheim	50.872	50.872	0	
Brea	12.221	12.221	0	
Buena Park	10.550	10.550	0	
Costa Mesa	15.827	15.827	0	
Cypress	6.622	6.622	0	
Dana Point	6.602	6.602	0	
Fountain Valley	9.065	9.065	0	
Fullerton	22.447	22.447	0	
Garden Grove	17.923	17.923	0	
Huntington Beach	27.612	27.612	0.209	3
Irvine	65.969	65.969	0	
Laguna Beach	8.932	8.932	0	
Laguna Hills	6.647	6.647	0	
Laguna Niguel	14.787	14.787	0	
Laguna Woods	3.306	3.306	0	
La Habra	7.360	7.369	0.009	1,2
Lake Forest	16.785	16.785	0	
La Palma	1.804	1.804	0	
Los Alamitos	4.089	4.089	0	
Mission Viejo	17.933	17.933	0	
Newport Beach	25.984	25.984	0	
Orange	25.783	25.783	0	
Placentia	6.621	6.621	0	
Rancho Santa Margarita	12.937	12.937	0	
San Clemente	18.357	18.357	0	
San Juan Capistrano	14.407	14.407	0	
Santa Ana	27.352	27.352	0	
Seal Beach	11.991	11.991	0	
Stanton	3.087	3.087	0	
Tustin	11.137	11.137	0	
Villa Park	2.078	2.078	0	
Westminster	10.070	10.070	0	
Yorba Linda	19.867	19.867	0	
Unincorporated	276.183	275.965	-0.218	1,2,3
Orange County	799.920	799.920	0.000	

Source: O.C. Geomatics, 2011 & 2012

*Area calculated in ArcGIS by CDR.

**Annual area change totals may not match detailed annexation information due to rounding.

1) Chestnut Annexation to the City of La Habra

Exhibit A

BISHOP

BRENDA

La Habra

303-101-37

303-101-38

303-101-36

303-101-39

303-101-35

303-101-40

CHESTNUT



Chestnut Annexation to the City of La Habra CA 09-11 (Expanded) Vicinity Map

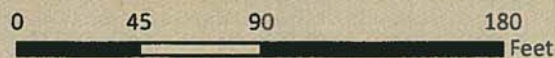

-  Chestnut Island Boundary
-  City of La Habra
-  Unincorporated

EXHIBIT "B"

ANNEXATION NO. CA 09 - 10
 TO THE CITY OF LA HABRA

THIS DOCUMENT WAS PREPARED BY ME OR UNDER
 MY DIRECT SUPERVISION.

DATED THIS 15TH DAY OF APRIL, 2011

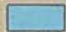
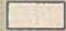
Craig S. Wehrman
 CRAIG S. WEHRMAN, L.S. 6131
 DEPUTY COUNTY SURVEYOR
 MY LICENSE EXPIRES: 03/31/2012



THIS PROPOSAL DOES MEET WITH THE APPROVAL OF
 THE COUNTY SURVEYOR'S OFFICE.

DATED THIS 15TH DAY OF APRIL, 2011

Raymond L. Mathe
 RAYMOND L. MATHE, L.S. 6185
 COUNTY SURVEYOR
 MY LICENSE EXPIRES: 03/31/2012



LEGEND:

- PROPOSED CITY BOUNDARIES SHOWN THUS
- EXISTING CITY BOUNDARIES SHOWN THUS
- 303-081-16 ASSESSOR PARCEL NUMBERS TYPICAL
- () RECORD PER ADJOINING ANNEXATION

LA HABRA
 COUNTY
 PLATS

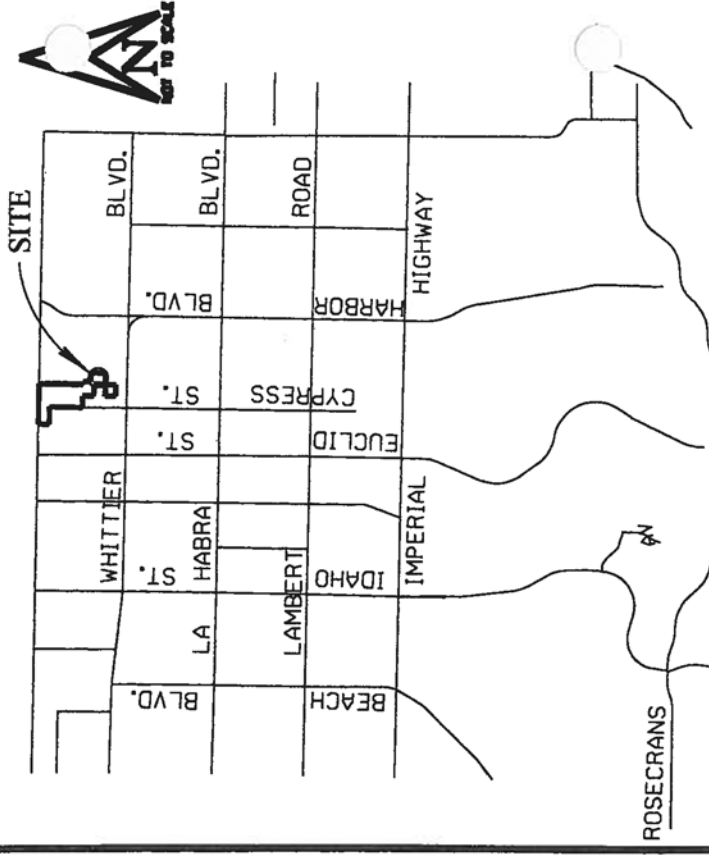

VICINITY MAP

- R1 - CITY OF LA HABRA ORDINANCE NO. 300 (KENBO ANNEXATION NO. 2)
- R2 - CITY OF LA HABRA RESOLUTION NO. 2686 (HARRIS 76-13 ANNEXATION)
- R3 - CITY OF LA HABRA ORDINANCE NO. 304 (JOHNSON ANNEXATION)
- R4 - CITY OF LA HABRA RESOLUTION NO. 2664 (KNIGHT 76-11 ANNEXATION)

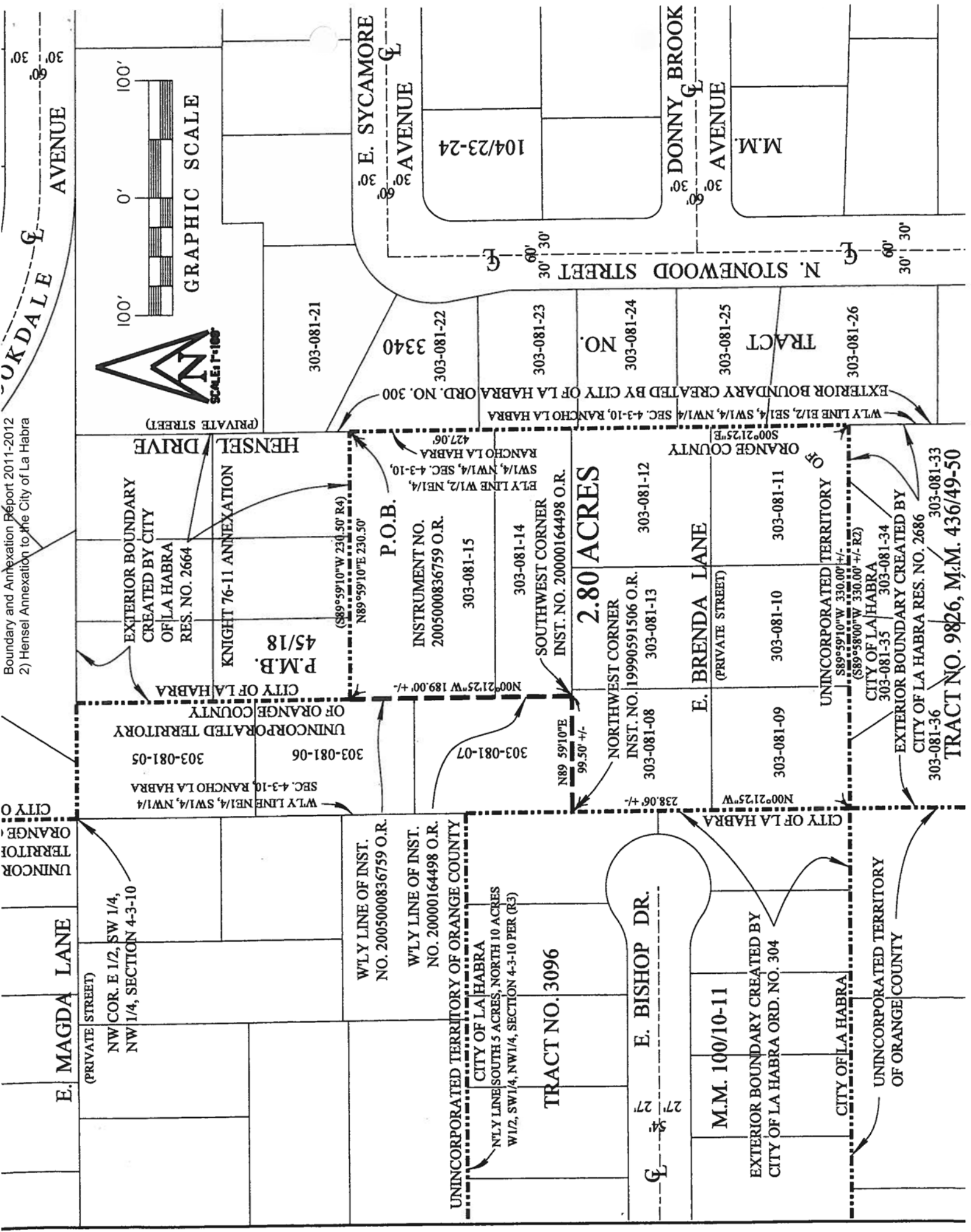

Boundary and Annexation Report 2011-2012
 2) Hensel Annexation to the City of La Habra

E. MAGDA LANE
 (PRIVATE STREET)
 NW COR. E 1/2, SW 1/4,
 NW 1/4, SECTION 4-3-10

UNINCORPORATED TERRITORY OF ORANGE COUNTY

WLY LINE NE1/4, SW1/4, NW1/4
 SEC. 4-3-10, RANCHO LA HABRA

UNINCORPORATED TERRITORY OF ORANGE COUNTY

TRACT NO. 3096
 UNINCORPORATED TERRITORY OF ORANGE COUNTY
 CITY OF LA HABRA
 NLY LINE SOUTH 5 ACRES, NORTH 10 ACRES
 W1/2, SW1/4, NW1/4, SECTION 4-3-10 PER (R3)

TRACT NO. 3096
 UNINCORPORATED TERRITORY OF ORANGE COUNTY
 CITY OF LA HABRA
 WLY LINE OF INST. NO. 2005000836759 O.R.
 WLY LINE OF INST. NO. 20000164498 O.R.

TRACT NO. 3096
 UNINCORPORATED TERRITORY OF ORANGE COUNTY
 CITY OF LA HABRA
 WLY LINE W1/2, NE1/4, SW1/4, NW1/4, SEC. 4-3-10, RANCHO LA HABRA
 427.06

TRACT NO. 3096
 UNINCORPORATED TERRITORY OF ORANGE COUNTY
 CITY OF LA HABRA
 WLY LINE W1/2, NE1/4, SW1/4, NW1/4, SEC. 4-3-10, RANCHO LA HABRA
 427.06

TRACT NO. 3096
 UNINCORPORATED TERRITORY OF ORANGE COUNTY
 CITY OF LA HABRA
 WLY LINE W1/2, NE1/4, SW1/4, NW1/4, SEC. 4-3-10, RANCHO LA HABRA
 427.06

TRACT NO. 3096
 UNINCORPORATED TERRITORY OF ORANGE COUNTY
 CITY OF LA HABRA
 WLY LINE W1/2, NE1/4, SW1/4, NW1/4, SEC. 4-3-10, RANCHO LA HABRA
 427.06

TRACT NO. 3096
 UNINCORPORATED TERRITORY OF ORANGE COUNTY
 CITY OF LA HABRA
 WLY LINE W1/2, NE1/4, SW1/4, NW1/4, SEC. 4-3-10, RANCHO LA HABRA
 427.06

TRACT NO. 3096
 UNINCORPORATED TERRITORY OF ORANGE COUNTY
 CITY OF LA HABRA
 WLY LINE W1/2, NE1/4, SW1/4, NW1/4, SEC. 4-3-10, RANCHO LA HABRA
 427.06

TRACT NO. 3096
 UNINCORPORATED TERRITORY OF ORANGE COUNTY
 CITY OF LA HABRA
 WLY LINE W1/2, NE1/4, SW1/4, NW1/4, SEC. 4-3-10, RANCHO LA HABRA
 427.06

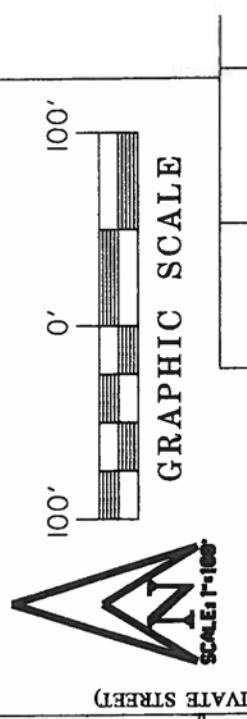

E. SYCAMORE AVENUE
E. BISHOP DR.
E. BRENDA LANE
E. MAGDA LANE

TRACT NO. 3096
 UNINCORPORATED TERRITORY OF ORANGE COUNTY
 CITY OF LA HABRA
 WLY LINE W1/2, NE1/4, SW1/4, NW1/4, SEC. 4-3-10, RANCHO LA HABRA
 427.06

TRACT NO. 3096
 UNINCORPORATED TERRITORY OF ORANGE COUNTY
 CITY OF LA HABRA
 WLY LINE W1/2, NE1/4, SW1/4, NW1/4, SEC. 4-3-10, RANCHO LA HABRA
 427.06

TRACT NO. 3096
 UNINCORPORATED TERRITORY OF ORANGE COUNTY
 CITY OF LA HABRA
 WLY LINE W1/2, NE1/4, SW1/4, NW1/4, SEC. 4-3-10, RANCHO LA HABRA
 427.06

TRACT NO. 3096
 UNINCORPORATED TERRITORY OF ORANGE COUNTY
 CITY OF LA HABRA
 WLY LINE W1/2, NE1/4, SW1/4, NW1/4, SEC. 4-3-10, RANCHO LA HABRA
 427.06

TRACT NO. 3096
 UNINCORPORATED TERRITORY OF ORANGE COUNTY
 CITY OF LA HABRA
 WLY LINE W1/2, NE1/4, SW1/4, NW1/4, SEC. 4-3-10, RANCHO LA HABRA
 427.06

TRACT NO. 3096
 UNINCORPORATED TERRITORY OF ORANGE COUNTY
 CITY OF LA HABRA
 WLY LINE W1/2, NE1/4, SW1/4, NW1/4, SEC. 4-3-10, RANCHO LA HABRA
 427.06

TRACT NO. 3096
 UNINCORPORATED TERRITORY OF ORANGE COUNTY
 CITY OF LA HABRA
 WLY LINE W1/2, NE1/4, SW1/4, NW1/4, SEC. 4-3-10, RANCHO LA HABRA
 427.06

TRACT NO. 3096
 UNINCORPORATED TERRITORY OF ORANGE COUNTY
 CITY OF LA HABRA
 WLY LINE W1/2, NE1/4, SW1/4, NW1/4, SEC. 4-3-10, RANCHO LA HABRA
 427.06

TRACT NO. 3096
 UNINCORPORATED TERRITORY OF ORANGE COUNTY
 CITY OF LA HABRA
 WLY LINE W1/2, NE1/4, SW1/4, NW1/4, SEC. 4-3-10, RANCHO LA HABRA
 427.06

TRACT NO. 3096
 UNINCORPORATED TERRITORY OF ORANGE COUNTY
 CITY OF LA HABRA
 WLY LINE W1/2, NE1/4, SW1/4, NW1/4, SEC. 4-3-10, RANCHO LA HABRA
 427.06

TRACT NO. 3096
 UNINCORPORATED TERRITORY OF ORANGE COUNTY
 CITY OF LA HABRA
 WLY LINE W1/2, NE1/4, SW1/4, NW1/4, SEC. 4-3-10, RANCHO LA HABRA
 427.06

TRACT NO. 3096
 UNINCORPORATED TERRITORY OF ORANGE COUNTY
 CITY OF LA HABRA
 WLY LINE W1/2, NE1/4, SW1/4, NW1/4, SEC. 4-3-10, RANCHO LA HABRA
 427.06

TRACT NO. 3096
 UNINCORPORATED TERRITORY OF ORANGE COUNTY
 CITY OF LA HABRA
 WLY LINE W1/2, NE1/4, SW1/4, NW1/4, SEC. 4-3-10, RANCHO LA HABRA
 427.06

TRACT NO. 3096
 UNINCORPORATED TERRITORY OF ORANGE COUNTY
 CITY OF LA HABRA
 WLY LINE W1/2, NE1/4, SW1/4, NW1/4, SEC. 4-3-10, RANCHO LA HABRA
 427.06

TRACT NO. 9826, M.M. 436/49-50
 CITY OF LA HABRA RES. NO. 2686
 EXTERIOR BOUNDARY CREATED BY
 CITY OF LA HABRA
 303-081-34
 303-081-35
 303-081-36
 303-081-33
 303-081-32
 303-081-31
 303-081-30
 303-081-29
 303-081-28
 303-081-27
 303-081-26
 303-081-25
 303-081-24
 303-081-23
 303-081-22
 303-081-21

EXHIBIT A

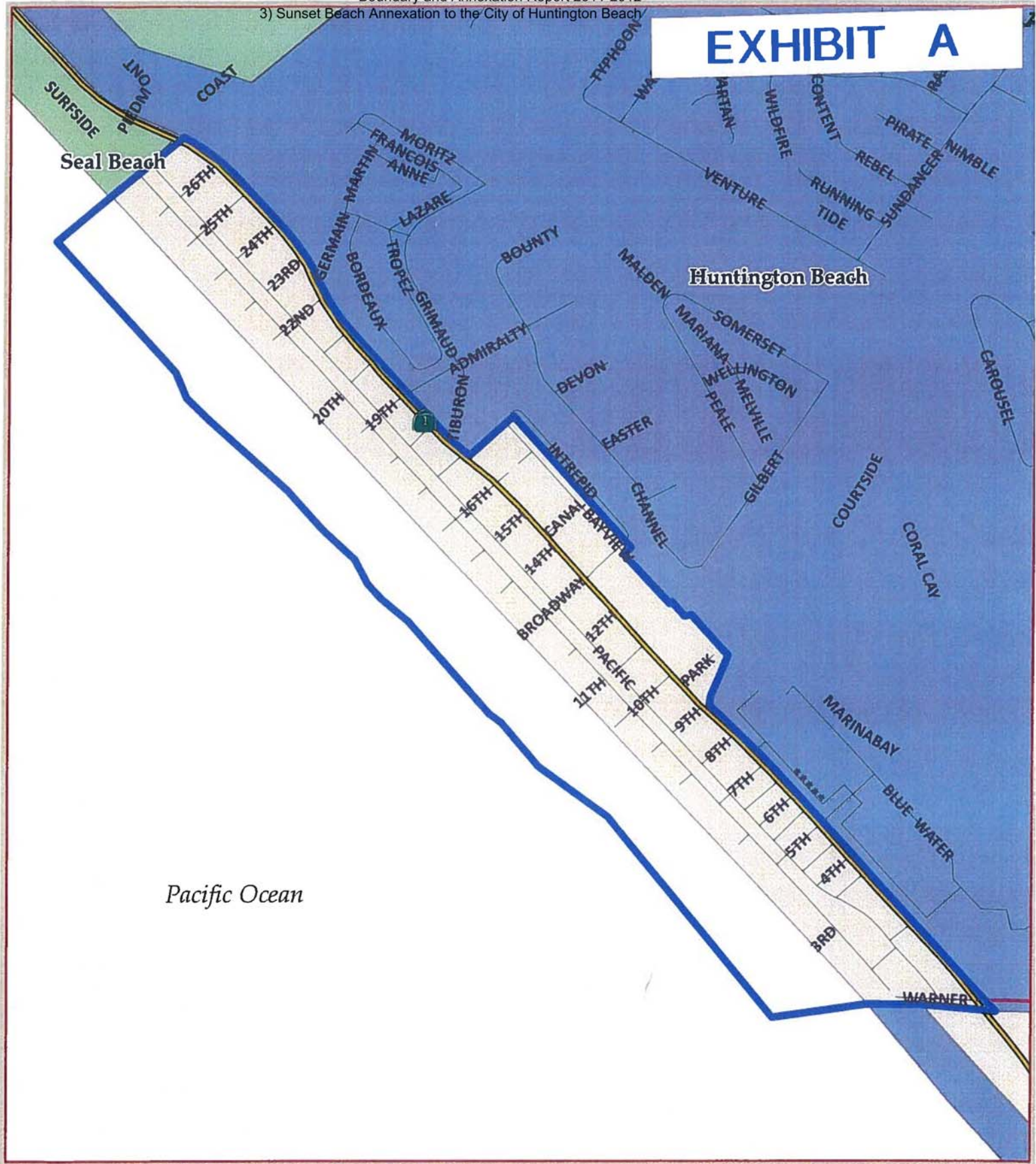

Proposed "Sunset Beach Annexation to the City of Huntington Beach"
(IA 10-05)
Vicinity Map

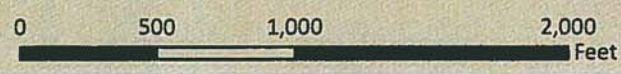
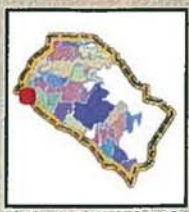

- Annexation Boundary
- Huntington Beach
- Seal Beach
- Unincorporated

EXHIBIT B

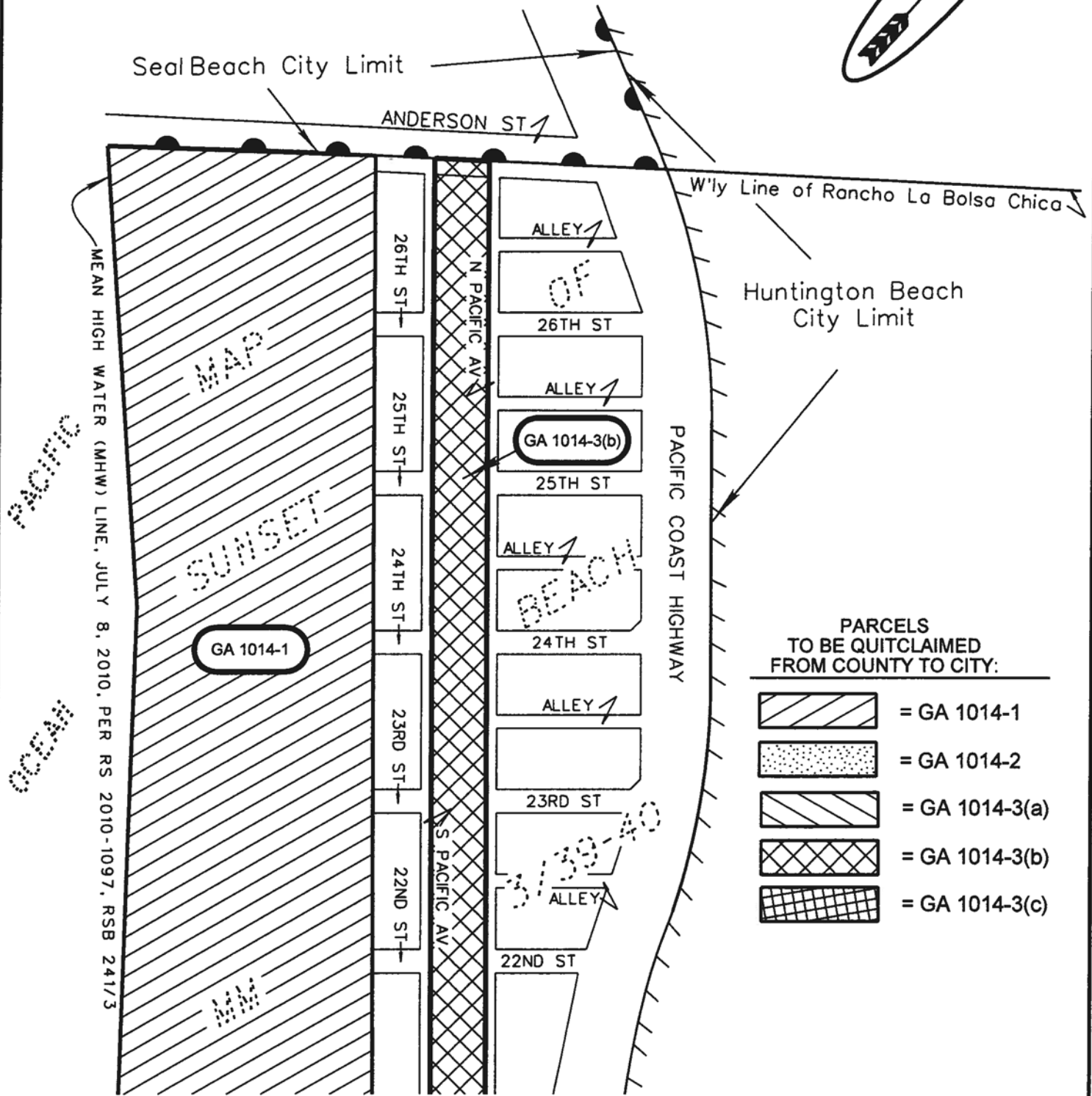
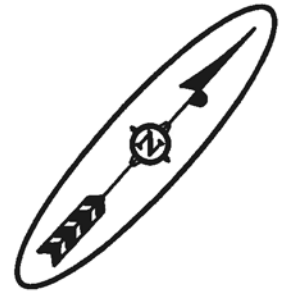

PARCELS TO BE QUITCLAIMED FROM COUNTY TO CITY:

	= GA 1014-1
	= GA 1014-2
	= GA 1014-3(a)
	= GA 1014-3(b)
	= GA 1014-3(c)

SEE PAGE 2

ORANGE COUNTY OC PUBLIC WORKS - RIGHT OF WAY ENGINEERING
RIGHT OF WAY MAP - COMPILED FROM PUBLIC RECORDS



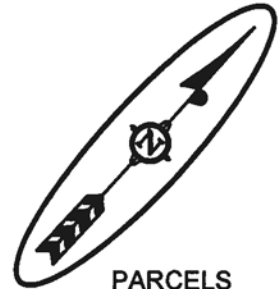

QUITCLAIM OF RIGHTS FROM COUNTY OF ORANGE TO THE CITY OF HUNTINGTON BEACH

SEE PAGE 1

EXHIBIT B

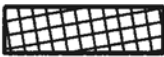

PARCELS TO BE QUITCLAIMED FROM COUNTY TO CITY:

-  = GA 1014-1
-  = GA 1014-2
-  = GA 1014-3(a)
-  = GA 1014-3(b)
-  = GA 1014-3(c)

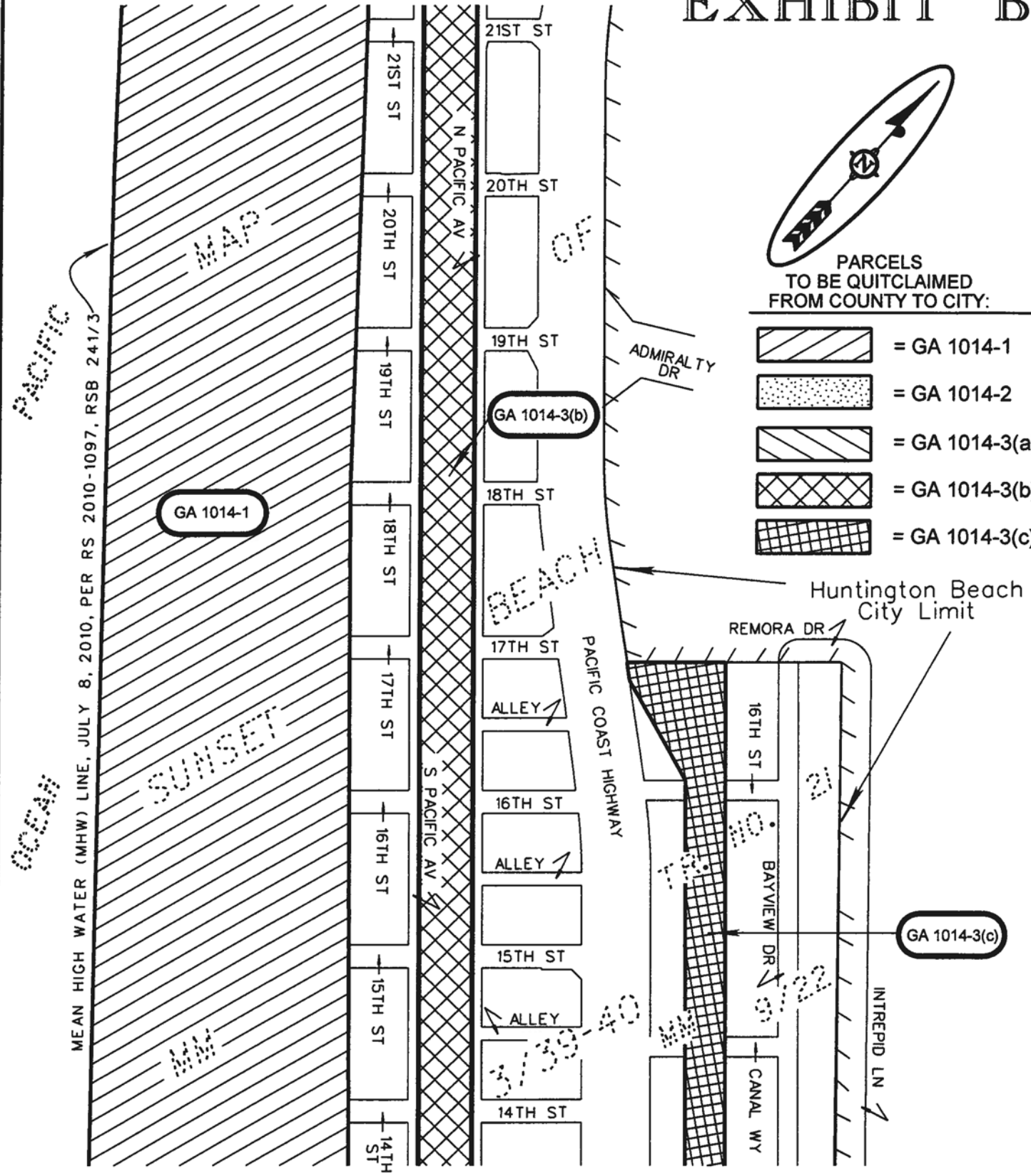

SEE PAGE 3

ORANGE COUNTY OC PUBLIC WORKS - RIGHT OF WAY ENGINEERING RIGHT OF WAY MAP - COMPILED FROM PUBLIC RECORDS

QUITCLAIM OF RIGHTS FROM COUNTY OF ORANGE TO THE CITY OF HUNTINGTON BEACH

PREP. BY: ARA

CHKD. BY: JDP

DATE: 11/09/10

SCALE : 1" = 200'

PAGE 2 OF 4

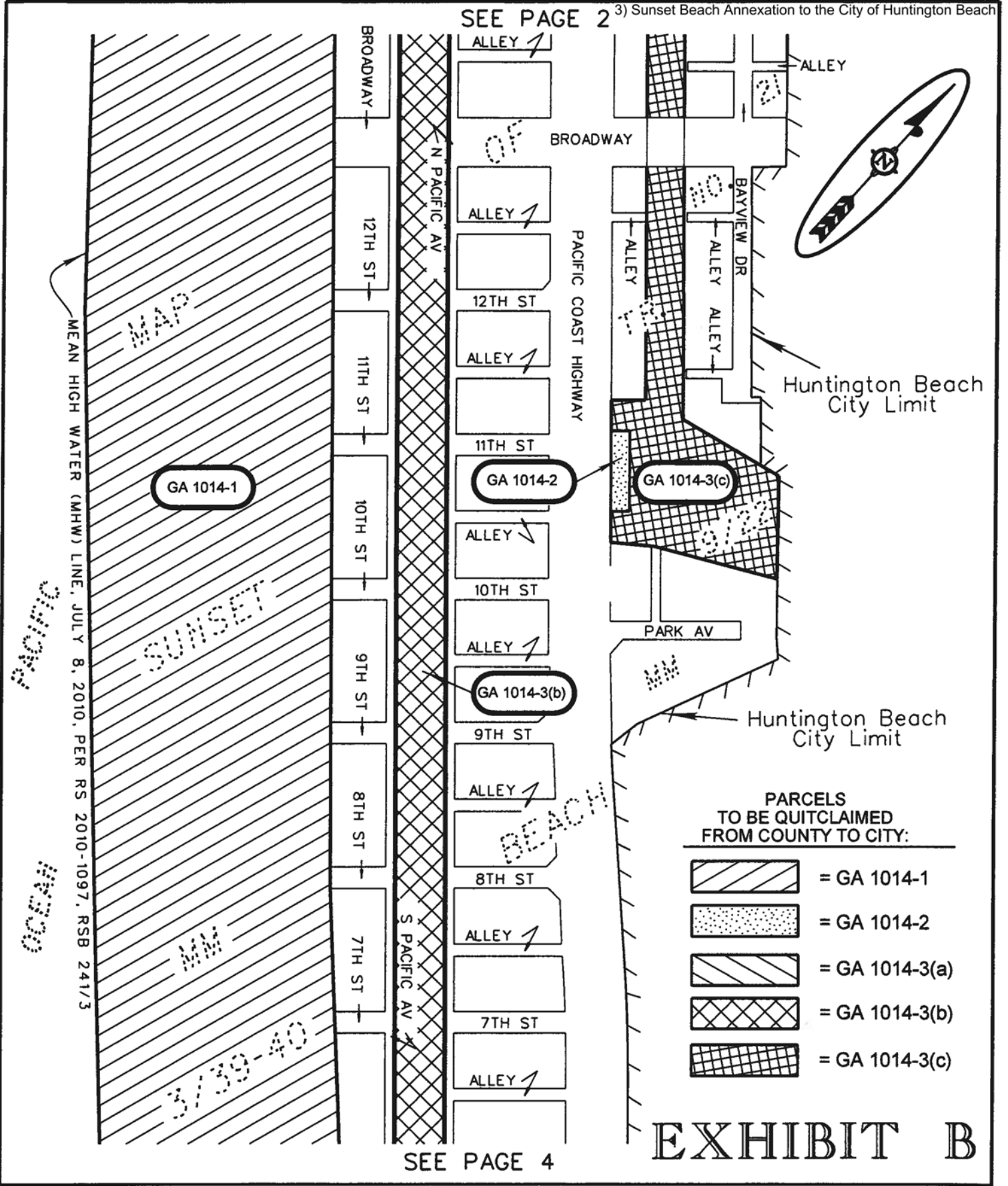

ORANGE COUNTY OC PUBLIC WORKS - RIGHT OF WAY ENGINEERING
 RIGHT OF WAY MAP - COMPILED FROM PUBLIC RECORDS

QUITCLAIM OF RIGHTS FROM COUNTY OF ORANGE TO THE CITY OF HUNTINGTON BEACH

SEE PAGE 3

EXHIBIT B

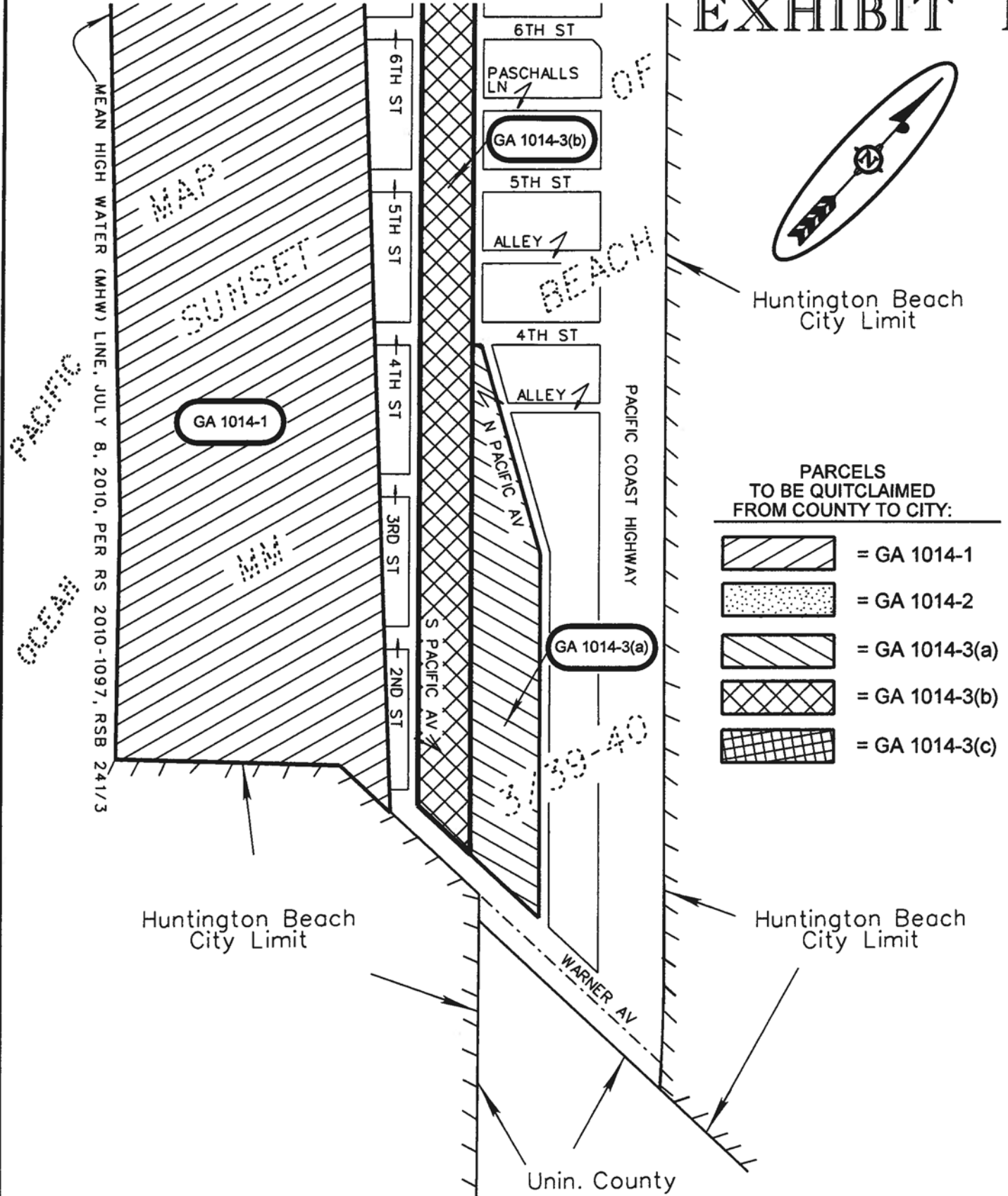

ORANGE COUNTY OC PUBLIC WORKS - RIGHT OF WAY ENGINEERING
 RIGHT OF WAY MAP - COMPILED FROM PUBLIC RECORDS

QUITCLAIM OF RIGHTS FROM COUNTY OF ORANGE TO THE CITY OF HUNTINGTON BEACH