

# Orange County Boundary and Annexation Report 2011-2012 (January 1)



1. Chestnut Annexation to the City of La Habra (CA 09-11E)
2. Hensel Annexation to the City of La Habra (CA 09-10)
3. Sunset Beach Annexation to the City of Huntington Beach (IA 10-05)

	January 1, 2012 Jurisdictions
	January 1, 2011 Jurisdictions

Source: OC Geomatics, 2011 & 2012  
 Note: Coastal differences due to measurement of mean high tide level. Official coastal city boundaries extend 3 miles offshore.

**Orange County Boundary and Annexation Report 2011-2012**

Jurisdiction	Total Area (Square Miles)*		Area Change 2011-2012**	Annexation Reference #
	January 1, 2011	January 1, 2012		
Aliso Viejo	6.921	6.921	0	
Anaheim	50.872	50.872	0	
Brea	12.221	12.221	0	
Buena Park	10.550	10.550	0	
Costa Mesa	15.827	15.827	0	
Cypress	6.622	6.622	0	
Dana Point	6.602	6.602	0	
Fountain Valley	9.065	9.065	0	
Fullerton	22.447	22.447	0	
Garden Grove	17.923	17.923	0	
Huntington Beach	27.402	27.612	0.209	3
Irvine	65.969	65.969	0	
Laguna Beach	8.932	8.932	0	
Laguna Hills	6.647	6.647	0	
Laguna Niguel	14.787	14.787	0	
Laguna Woods	3.306	3.306	0	
La Habra	7.360	7.369	0.009	1,2
Lake Forest	16.785	16.785	0	
La Palma	1.804	1.804	0	
Los Alamitos	4.089	4.089	0	
Mission Viejo	17.933	17.933	0	
Newport Beach	25.984	25.984	0	
Orange	25.783	25.783	0	
Placentia	6.621	6.621	0	
Rancho Santa Margarita	12.937	12.937	0	
San Clemente	18.357	18.357	0	
San Juan Capistrano	14.407	14.407	0	
Santa Ana	27.352	27.352	0	
Seal Beach	11.991	11.991	0	
Stanton	3.087	3.087	0	
Tustin	11.137	11.137	0	
Villa Park	2.078	2.078	0	
Westminster	10.070	10.070	0	
Yorba Linda	19.867	19.867	0	
Unincorporated	276.183	275.965	-0.218	1,2,3
<b>Orange County</b>	<b>799.920</b>	<b>799.920</b>	<b>0.000</b>	

Source: O.C. Geomatics, 2011 & 2012

\*Area calculated in ArcGIS by CDR.

\*\*Annual area change totals may not match detailed annexation information due to rounding.

**Detailed Annexation List:**

- 1) Chestnut Annexation to the City of La Habra (CA 09-11E)  
Effective: 1/20/2011  
From Unincorporated Orange County to La Habra  
Inhabited  
2.68 acres (0.00419 sq. miles)
  
- 2) Hensel Annexation to the City of La Habra (CA 09-10)  
Effective: 4/12/2011  
From Unincorporated Orange County to La Habra  
Inhabited  
2.80 acres (0.00438 sq. miles)
  
- 3) Sunset Beach Annexation to the City of Huntington Beach (IA 10-05)  
Effective: 8/22/2011  
From Unincorporated Orange County to Huntington Beach  
Inhabited  
133.88 acres (0.20919 sq. miles)

**Notes:**

Benchmark 2015.

Some jurisdictions' legal boundary extends three miles off the coast.

A fixed boundary line at the coast was created in November 2014 based on high-resolution county-wide aerial imagery that was captured on June 19, 2013, to approximate the ocean waterline and to eliminate artificial land area changes to jurisdictions adjacent to the Orange County coast. This coast line does not define any vertical datum such as mean high tide, mean sea level, or mean lower low tide.

This reference line was developed through a collaboration of OC Public Works, OC LAFCO, and CDR; it has no legal value; and its purpose is for CDR's use in reporting population density and jurisdictional annexations.

For official legal boundaries, contact the County of Orange Surveyor's office

<http://ocpublicworks.com/survey/>



# EXHIBIT "B"

## ANNEXATION NO. CA 09 - 10

### TO THE CITY OF LA HABRA

THIS DOCUMENT WAS PREPARED BY ME OR UNDER MY DIRECT SUPERVISION.

DATED THIS 15<sup>TH</sup> DAY OF APRIL, 2011

*Craig S. Wehrman*  
 CRAIG S. WEHRMAN, L.S. 6131  
 DEPUTY COUNTY SURVEYOR  
 MY LICENSE EXPIRES: 03/31/2012



THIS PROPOSAL DOES MEET WITH THE APPROVAL OF THE COUNTY SURVEYOR'S OFFICE.

DATED THIS 15<sup>TH</sup> DAY OF April, 2011

*Raymond L. Mathe*  
 RAYMOND L. MATHE, L.S. 6185  
 COUNTY SURVEYOR  
 MY LICENSE EXPIRES: 03/31/2012

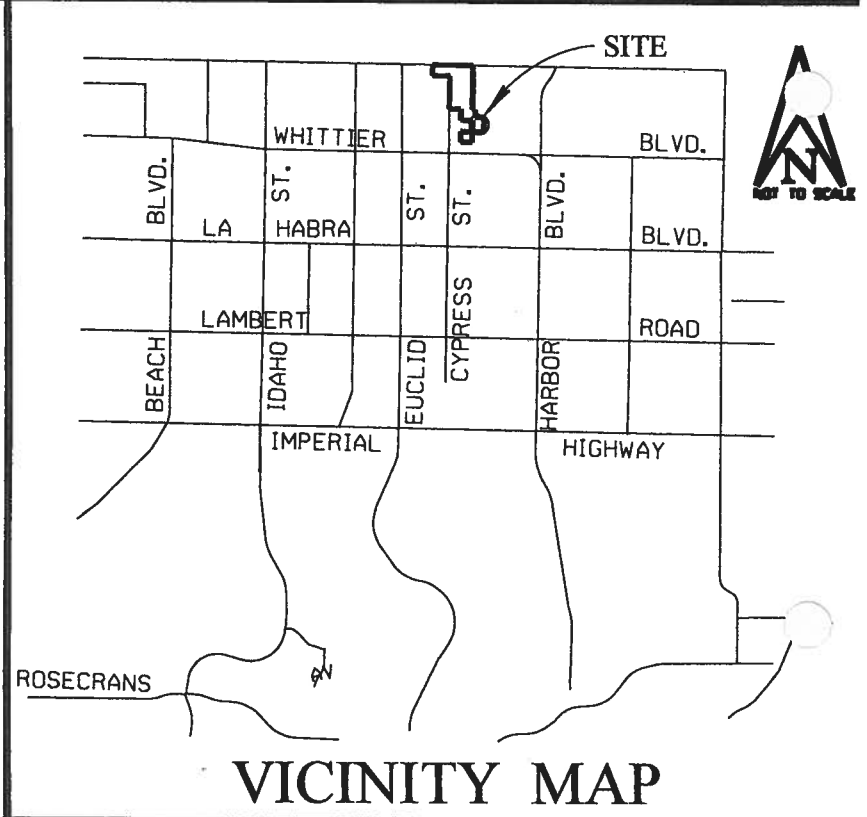

**LEGEND:**

- PROPOSED CITY BOUNDARIES SHOWN THUS
- ..... EXISTING CITY BOUNDARIES SHOWN THUS
- 303-081-16 ASSESSOR PARCEL NUMBERS TYPICAL
- ( ) RECORD PER ADJOINING ANNEXATION

- R1 - CITY OF LA HABRA ORDINANCE NO. 300 (KENBO ANNEXATION NO. 2)
- R2 - CITY OF LA HABRA RESOLUTION NO. 2686 (HARRIS 76-13 ANNEXATION)
- R3 - CITY OF LA HABRA ORDINANCE NO. 304 (JOHNSON ANNEXATION)
- R4 - CITY OF LA HABRA RESOLUTION NO. 2664 (KNIGHT 76-11 ANNEXATION)

LATED  
 OF  
 INTY  
 A HABRA

OKDALE AVENUE  
60' 30"

E. MAGDA LANE

UNINCORPORATED TERRITORY OF ORANGE COUNTY

(PRIVATE STREET)  
NW COR. E 1/2, SW 1/4,  
NW 1/4, SECTION 4-3-10

WLY LINE NE 1/4, SW 1/4, NW 1/4  
SEC. 4-3-10, RANCHO LA HABRA

UNINCORPORATED TERRITORY OF ORANGE COUNTY CITY OF LA HABRA

EXTERIOR BOUNDARY CREATED BY CITY OF LA HABRA RES. NO. 2664



100' 0' 100'  
GRAPHIC SCALE  
SCALE: 1"=100'

KNIGHT 76-11 ANNEXATION

P.M.B. 45/18

HENSEL DRIVE (PRIVATE STREET)

303-081-21

WLY LINE OF INST. NO. 2005000836759 O.R.

WLY LINE OF INST. NO. 20000164498 O.R.

(S89°59'10"W 230.50' R4)  
N89°59'10"E 230.50'

P.O.B.

INSTRUMENT NO. 2005000836759 O.R.

303-081-15

UNINCORPORATED TERRITORY OF ORANGE COUNTY

CITY OF LA HABRA  
NLY LINE SOUTH 5 ACRES, NORTH 10 ACRES  
W1/2, SW1/4, NW1/4, SECTION 4-3-10 PER (R3)

TRACT NO. 3096

WLY LINE NE 1/4, SW 1/4, NW 1/4, SEC. 4-3-10, RANCHO LA HABRA

N00°21'25"W 189.00' +/-

303-081-14

SOUTHWEST CORNER INST. NO. 20000164498 O.R.

2.80 ACRES

N89°59'10"E 99.50' +/-

NORTHWEST CORNER INST. NO. 19990591506 O.R.

303-081-08

303-081-13

E. BISHOP DR.

M.M. 100/10-11

EXTERIOR BOUNDARY CREATED BY CITY OF LA HABRA ORD. NO. 304

E. BRENDA LANE (PRIVATE STREET)

CITY OF LA HABRA  
N00°21'25"W

303-081-09

303-081-10

303-081-11

UNINCORPORATED TERRITORY OF ORANGE COUNTY

(S89°59'10"W 330.00' +/-)  
(S89°58'00"W 330.00' +/- R2)

CITY OF LA HABRA

EXTERIOR BOUNDARY CREATED BY CITY OF LA HABRA RES. NO. 2686

303-081-36

303-081-33

TRACT NO. 9826, M.M. 436/49-50

ORANGE COUNTY  
S00°21'25"E

WLY LINE E 1/2, SE 1/4, SW 1/4, NW 1/4, SEC. 4-3-10, RANCHO LA HABRA

EXTERIOR BOUNDARY CREATED BY CITY OF LA HABRA ORD. NO. 300

303-081-22

303-081-23

NO.

303-081-24

303-081-25

TRACT

303-081-26

N. STONEWOOD STREET

E. SYCAMORE AVENUE

104/23-24

DONNY BROOK AVENUE

M.M.





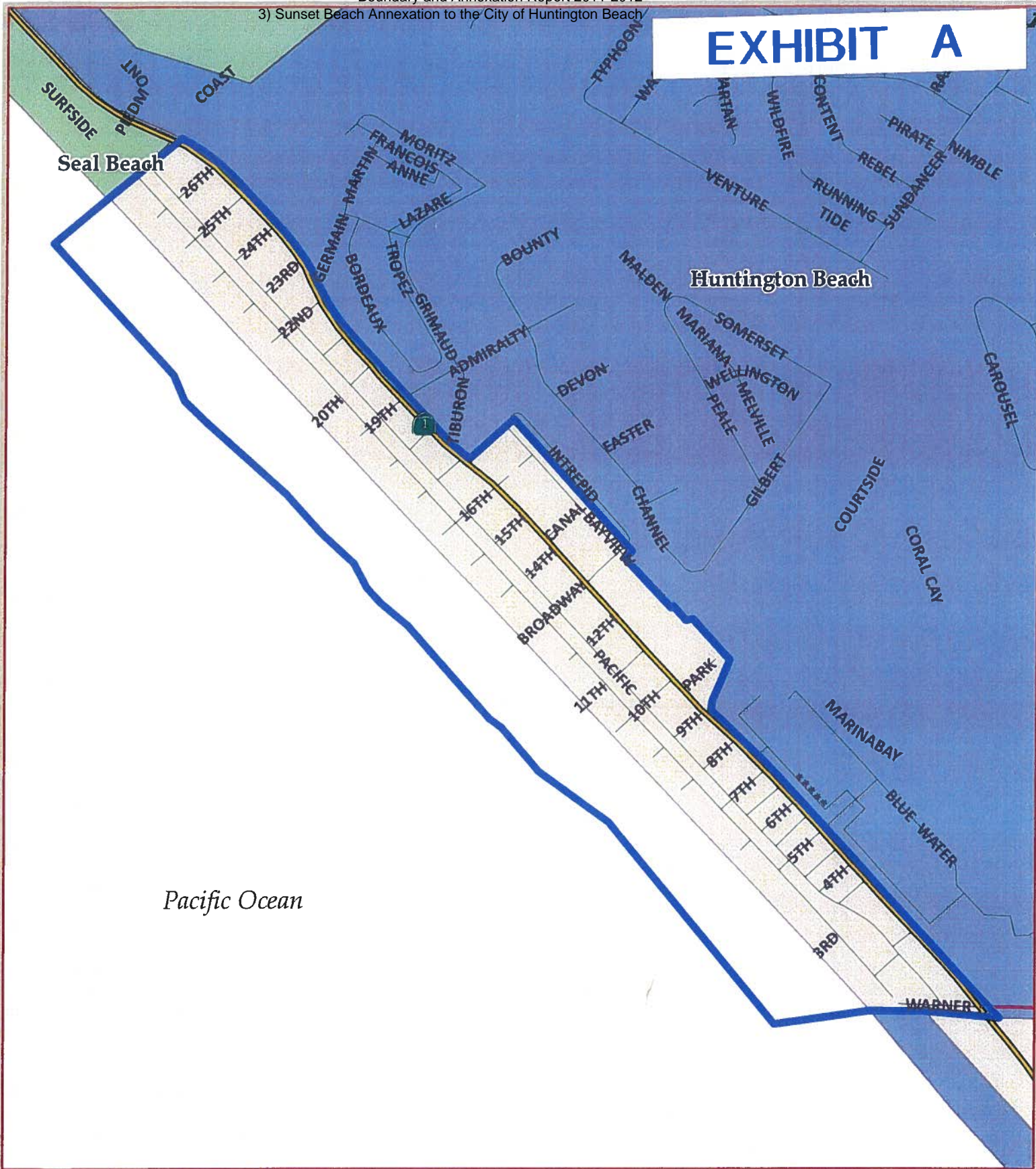

# EXHIBIT A



**Proposed "Sunset Beach Annexation to the City of Huntington Beach"**  
(IA 10-05)  
**Vicinity Map**



-  Annexation Boundary
-  Huntington Beach
-  Seal Beach
-  Unincorporated

# EXHIBIT B

## Proposed "Sunset Beach Annexation" (AN 10-\_\_\_)

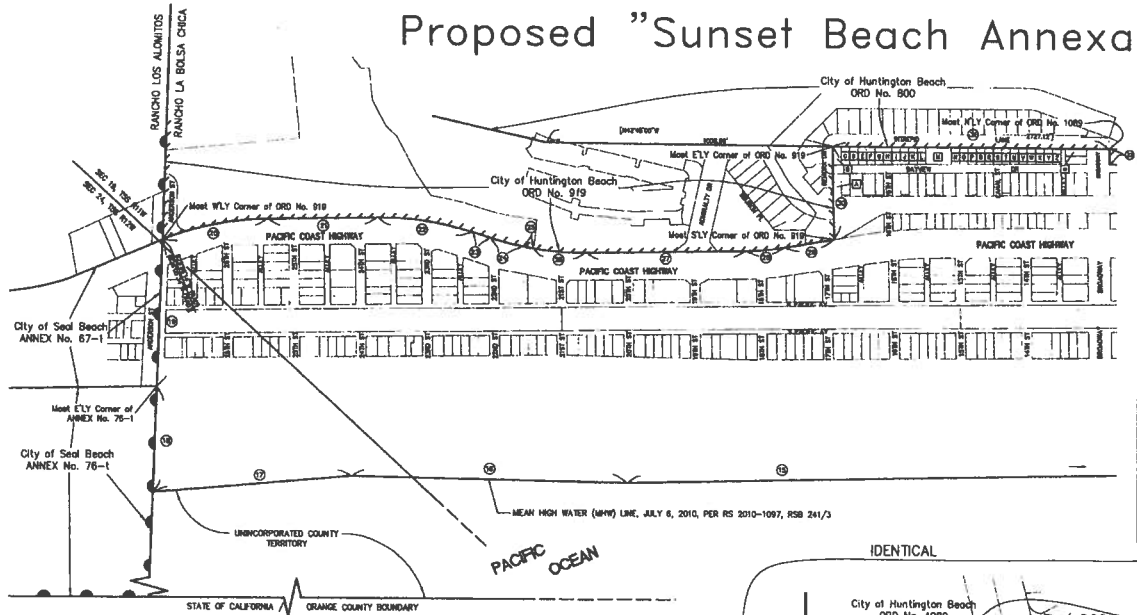

ASSESSOR'S PARCEL NUMBERS			
(A) A.P.N.	(B) A.P.N.	(C) A.P.N.	(D) A.P.N.
A	178-581-50	S	178-531-44
B	178-581-21	T	178-531-02
C	178-581-22	U	178-531-03
D	178-581-23	Y	178-531-42
E	178-581-41	W	178-531-45
F	178-581-40	X	178-531-08
G	178-581-28	Y	178-531-07
H	178-581-27	Z	178-531-43
I	178-581-28	a	178-531-08
J	178-581-29	b	178-532-81
K	178-581-30	c	178-532-44
L	178-581-31	d	178-532-45
M	178-581-43	a	178-532-46
N	178-581-33	i	178-532-47
O	178-581-38	g	178-532-48
P	178-581-37	h	178-532-49
Q	178-581-38	i	178-532-78
R	178-581-38		

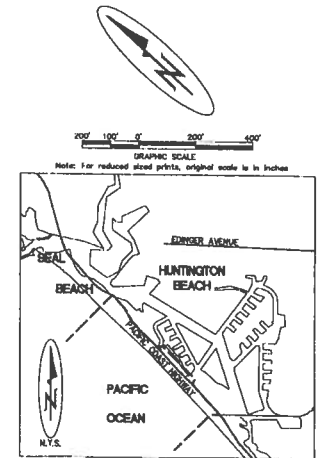

**LEGEND**

- EXISTING CITY OF HUNTINGTON BEACH BOUNDARY
- EXISTING CITY OF SEAL BEACH BOUNDARY

DATA TABLE							
①	BEARING/DELTA	RADIUS	LENGTH	②	BEARING/DELTA	RADIUS	LENGTH
1	<< S 21°43'12" W >>	248.38'	20	[20°32'30"]		1060'	380.17'
2	<< S 07°58'07" W >>	53.74'	21	[S 43°21'27" E S 43°28'48" E			398.02'
3	<< 01°14'30" >>	2840'	83.71'	[0°27'12"]		1060'	341.40'
4	<< S 47°01'54" E >>	278.28'	23	[S 24°54'15" E S 28°01'36" E			63.84'
5	<< 03°38'20" >>	3080'	195.23'	[0°10'23"]		840'	117.88'
6	<< S 43°22'34" E >>	1599.82'	25	[S 32°04'38" E S 32°11'36" E			35.23'
7	03°28'55"	3050'	183.58'	[11°20'58"]		840'	186.20'
8	S 80°51'33" W	377.41'	27	[S 43°25'38" E S 43°23'37" E			563.44'
9	[N 42°28'13" W N 43°22'54" W	40.61'	28	[08°20'46"]		840'	136.93'
10	[N 80°12'28" W S 80°10'33" W S 48°10'14" W S 48°10'33" W	281.58'	28	[S 01°48'22" E S 31°53'45" E			178.28'
11	[S 80°08'14" W S 48°10'33" W	344.56'	30	[N 48°30'07" E N 48°31'47" E			323.43'
12	[N 41°43'52" W N 42°38'48" W	388.69'	31	[S 42°45'00" E S 42°28'54" E			890.00'
13	[N 44°30'07" W N 44°48'58" W	1065.55'	32	[N 48°28'48" E N 48°45'11" E			98.00'
14	[N 43°38'24" W N 43°32'21" W	1283.71'	33	<S 43°31'15" E S 43°14'48" E			378.00'
15	[N 42°44'41" W N 43°44'38" W	1708.89'	34	[N 48°28'48" E N 48°45'11" E			15.00'
16	[N 40°28'12" W N 41°23'09" W	868.82'	35	<S 43°31'15" E S 43°14'48" E			111.77'
17	[N 42°23'07" W N 47°20'53" E	703.78'	36	[N 73°20'07" E N 73°48'28" E			33.80'
18	[N 50°30'33" E N 49°38'38" E	368.70'	37	[S 42°40'00" E S 42°28'54" E			281.60'
19	[N 48°32'07" E N 48°32'38" E	511.00'	38	[S 47°30'07" E S 47°13'54" E			35.00'

**BASIS OF BEARINGS**

The northwesterly line of parcel 2 as described in Ordinance Number 920 having a bearing of S 21°43'12" W is the basis of bearing.

**REFERENCE**

- ( ) RECORDED PER ORD. No. 1128 TO CITY OF HUNTINGTON BEACH
- [ ] RECORDED PER ORD. No. 800 TO CITY OF HUNTINGTON BEACH
- [ ] RECORDED PER ORD. No. 919 TO CITY OF HUNTINGTON BEACH
- [ ] RECORDED PER ANNEX No. 67-1 & 76-1 TO CITY OF SEAL BEACH
- [ ] RECORDED PER RS 2010-1087, RSB 241/3
- <> RECORDED PER ORD. No. 1089 TO CITY OF HUNTINGTON BEACH
- <<> RECORDED PER ORD. No. 920 TO CITY OF HUNTINGTON BEACH

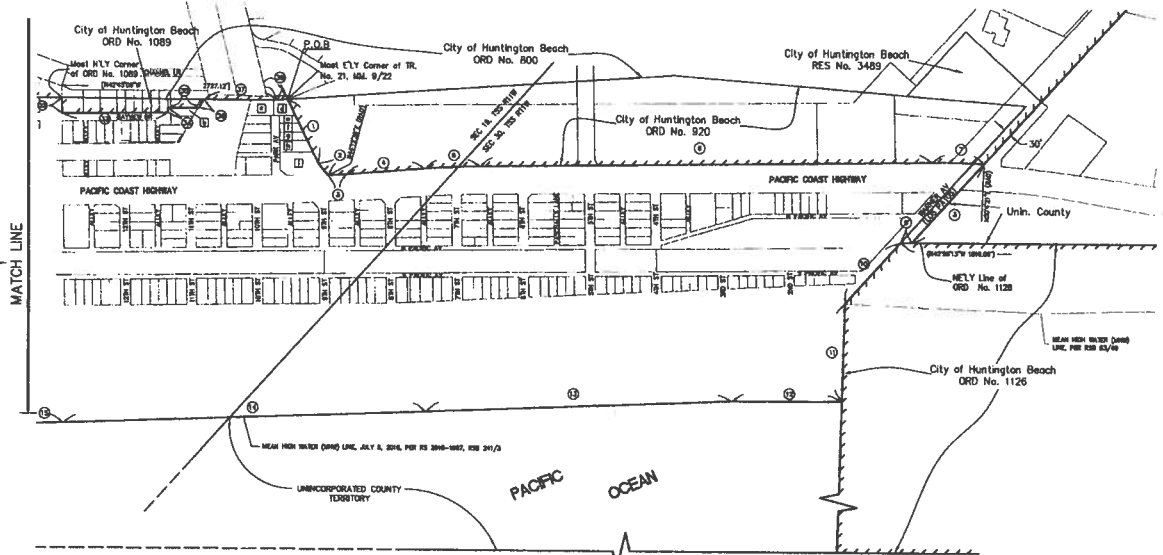

**SURVEYOR'S STATEMENT**  
 This proposal was prepared by me or under my supervision

Jeremy L. Evans  
 J.L.E. L.S. 5282  
 EXPIRATION DATE: DECEMBER 31, 2011



**COUNTY SURVEYOR'S STATEMENT**  
 This proposal does meet the approval of the Orange County Surveyor's Office

Raymond L. Mathe, County Surveyor, L.S. 7212  
 EXPIRATION DATE: MARCH 31, 2012

THIS PARCEL CONTAINS A LAND AREA OF 133.88 ACRES +/-.

CITY OF HUNTINGTON BEACH / RIGHT OF WAY ENGINEERING  
 Proposed "Sunset Beach Annexation" (AN 10-\_\_\_)

PREPARED A.G.R.	CHECKED P.J.F.	SCALE 1"=200'	DATE 11/08/2010
--------------------	-------------------	------------------	--------------------

# EXHIBIT B

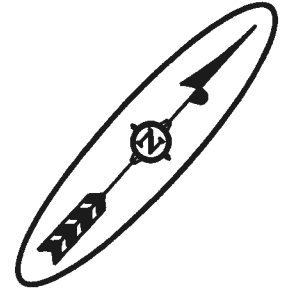

Seal Beach City Limit

ANDERSON ST

W'y Line of Rancho La Bolsa Chica



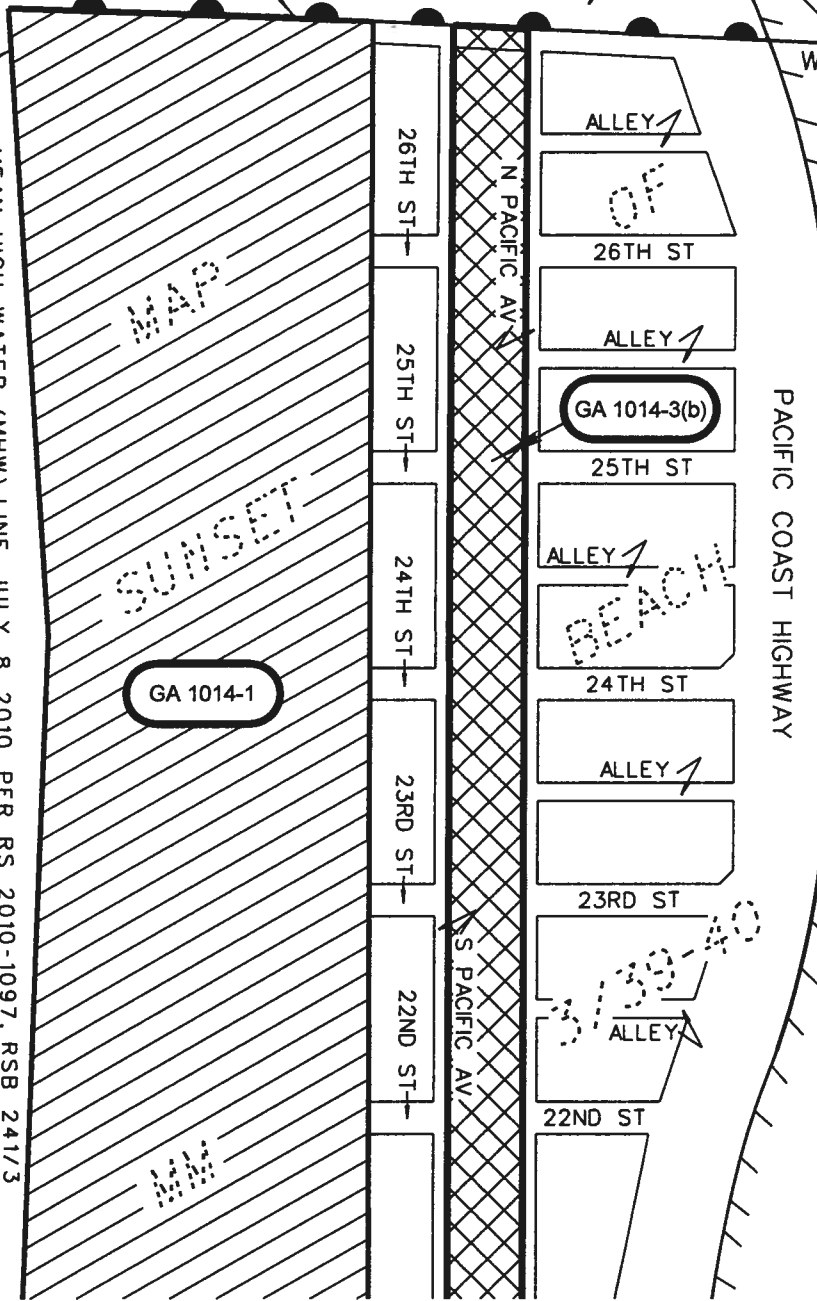

Huntington Beach City Limit

MEAN HIGH WATER (MHW) LINE, JULY 8, 2010, PER RS 2010-1097, RSB 241/3

PACIFIC COAST HIGHWAY



PARCELS TO BE QUITCLAIMED FROM COUNTY TO CITY:

-  = GA 1014-1
-  = GA 1014-2
-  = GA 1014-3(a)
-  = GA 1014-3(b)
-  = GA 1014-3(c)

SEE PAGE 2

ORANGE COUNTY OC PUBLIC WORKS - RIGHT OF WAY ENGINEERING  
RIGHT OF WAY MAP - COMPILED FROM PUBLIC RECORDS

QUITCLAIM OF RIGHTS FROM COUNTY OF ORANGE TO THE CITY OF HUNTINGTON BEACH



# EXHIBIT B

SEE PAGE 1

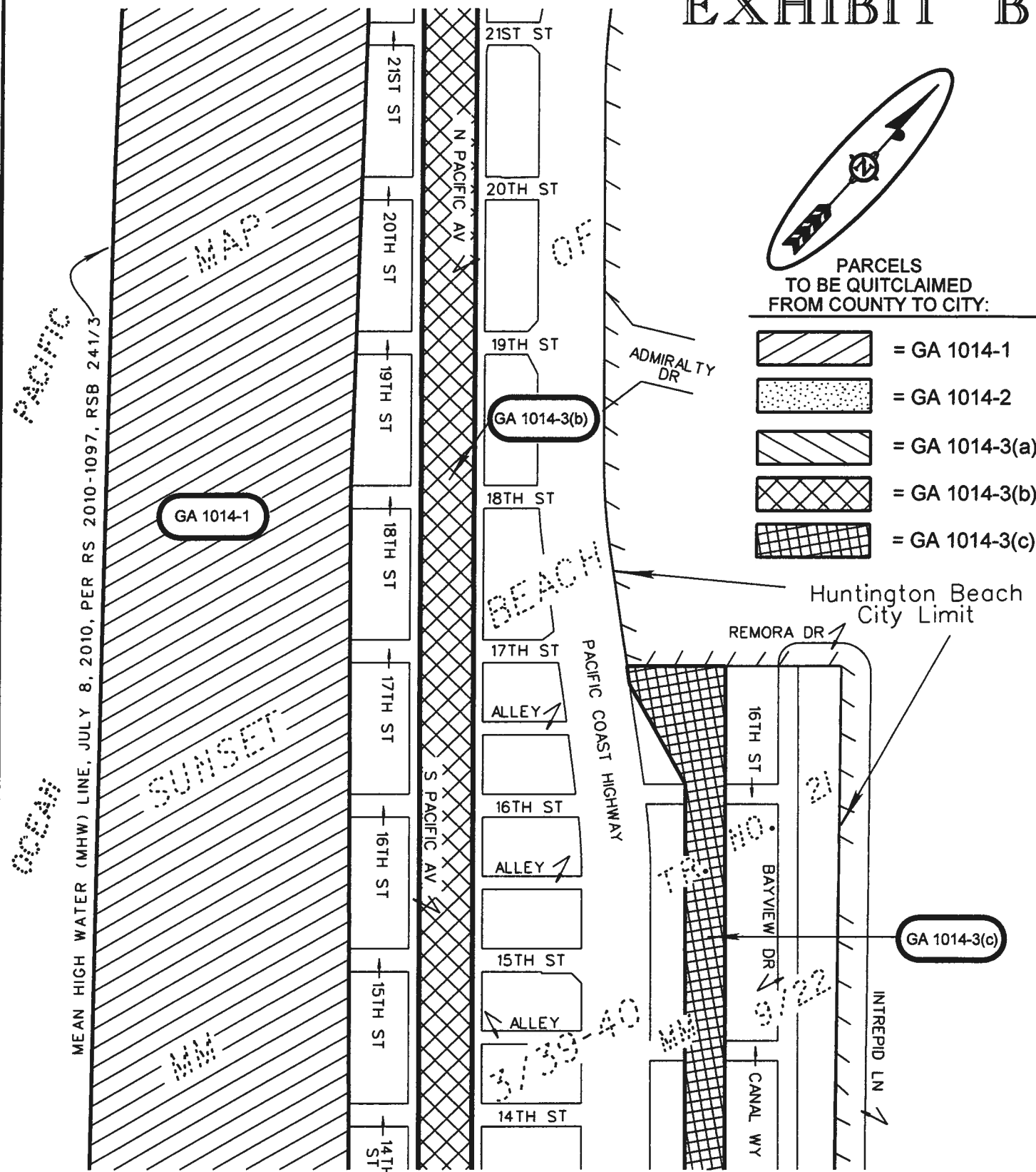

SEE PAGE 3

## ORANGE COUNTY OC PUBLIC WORKS - RIGHT OF WAY ENGINEERING RIGHT OF WAY MAP - COMPILED FROM PUBLIC RECORDS

QUITCLAIM OF RIGHTS FROM COUNTY OF ORANGE TO THE CITY OF HUNTINGTON BEACH

PREP. BY: ARA

CHKD. BY: JDP

DATE: 11/09/10

SCALE : 1" = 200'

PAGE 2 OF 4

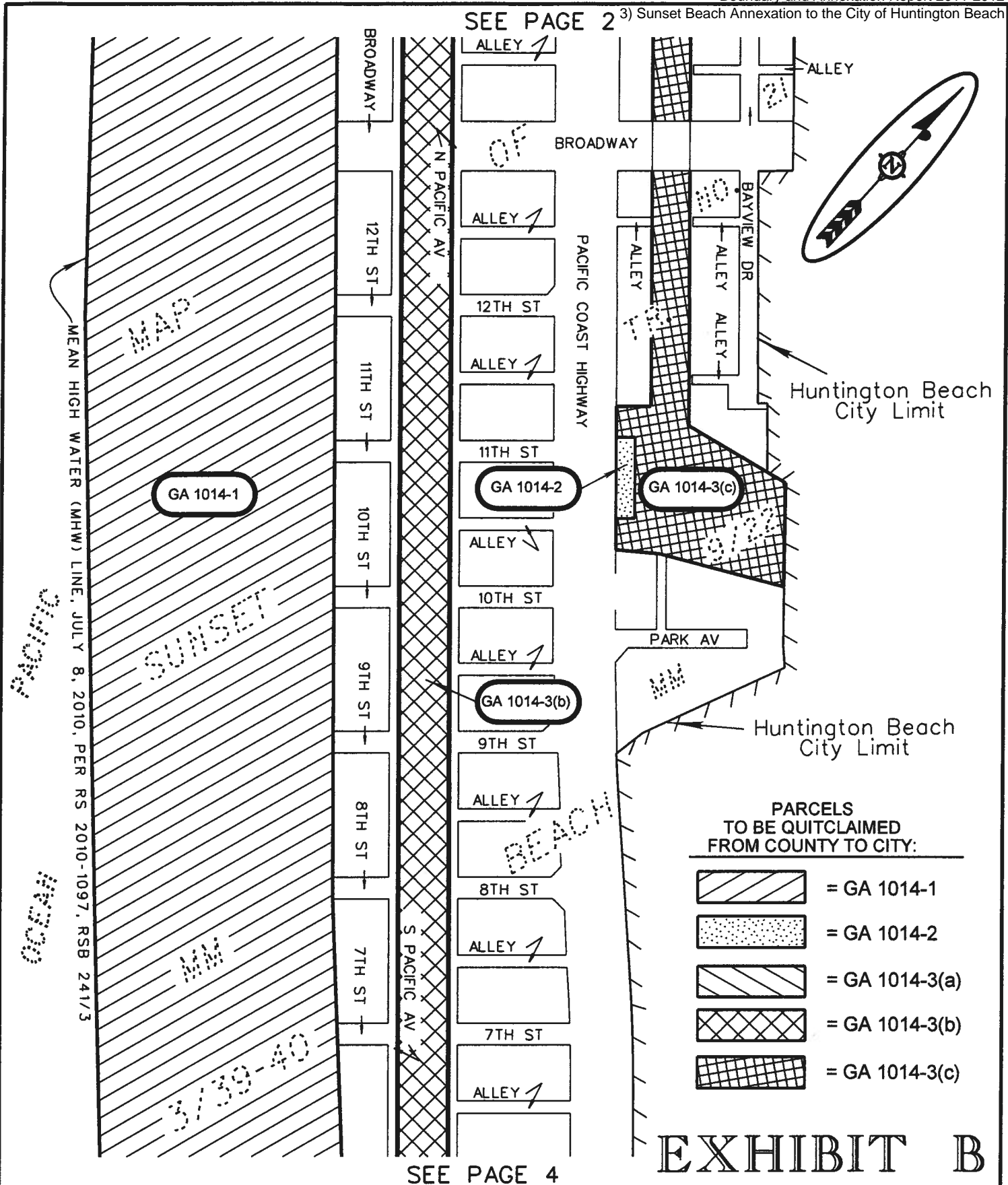

ORANGE COUNTY OC PUBLIC WORKS - RIGHT OF WAY ENGINEERING  
 RIGHT OF WAY MAP - COMPILED FROM PUBLIC RECORDS

QUITCLAIM OF RIGHTS FROM COUNTY OF ORANGE TO THE CITY OF HUNTINGTON BEACH

